

BACKING PLATE WITH CUTOUT FOR THE NAV/STROBE LIGHT AND HOLES FOR THE MOUNTING SCREWS.

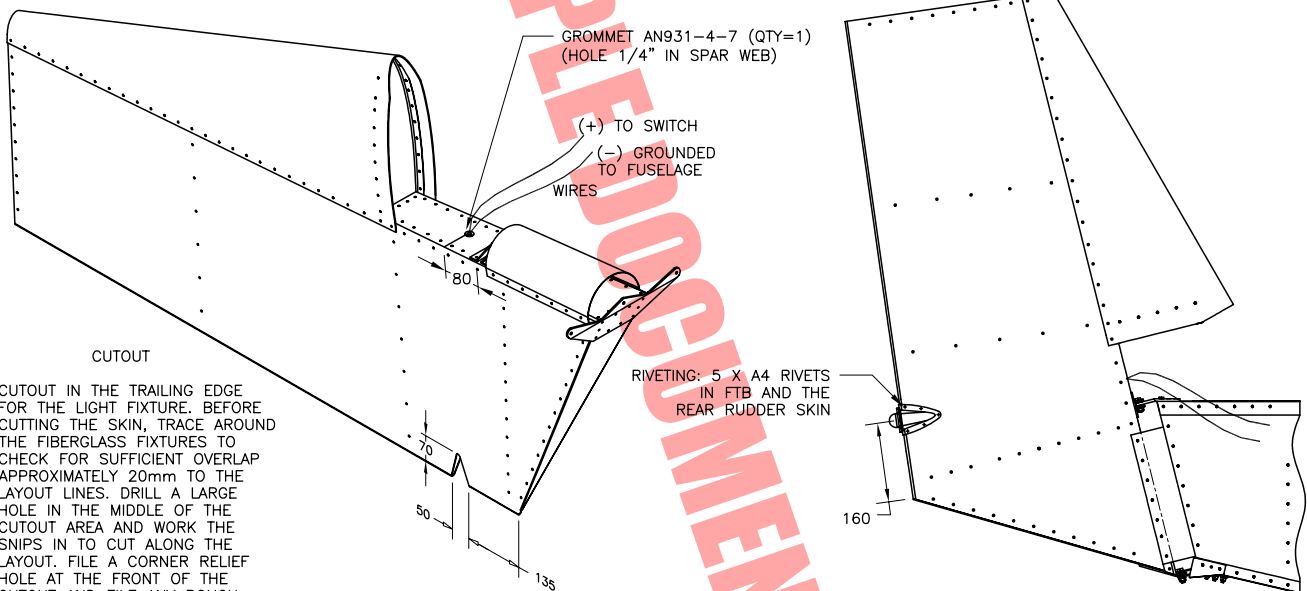

CUTOUT IN THE TRAILING EDGE FOR THE LIGHT FIXTURE. BEFORE CUTTING THE SKIN, TRACE AROUND THE FIBERGLASS FIXTURES TO CHECK FOR SUFFICIENT OVERLAP APPROXIMATELY 20mm TO THE LAYOUT LINES. DRILL A LARGE HOLE IN THE MIDDLE OF THE CUTOUT AREA AND WORK THE SNIPS IN TO CUT ALONG THE LAYOUT. FILE A CORNER RELIEF HOLE AT THE FRONT OF THE CUTOUT AND FILE ANY ROUGH EDGES.

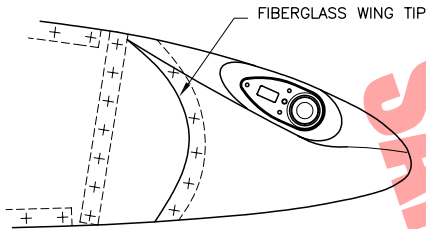
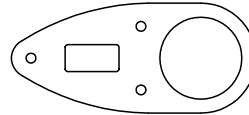
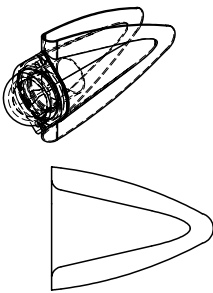

REAR VIEW

FTB **TAIL LIGHT MOUNTING BRACKET**
FIBERGLASS (1 REQ'D)

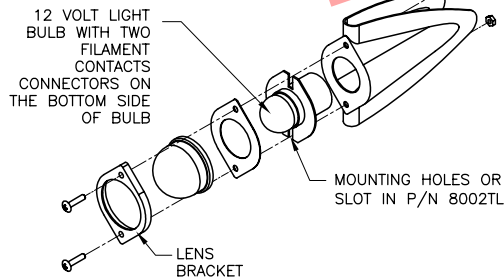

8002TL **WHITE POSITION TAIL LIGHT**
ASSEMBLY (1 REQ'D)

POSITION LIGHT

DRILL/CUT OR FILE A 1" HOLE IN THE FIBERGLASS MOUNTING BRACKET FOR THE LIGHT FIXTURE BODY.

CENTER THE LENS BRACKET OVER THE LIGHT FIXTURE AND DRILL THE TOP AND BOTTOM HOLE FOR THE SCREW WITH A #20 DRILL.

CONNECT THE ELECTRIC WIRE TO LIGHT BULB FIXTURE. TWO #16 WIRES REQUIRED: ONE FOR THE GROUND AND THE OTHER IS THE POSITIVE LEAD.

SCREW THE ASSEMBLY TO THE FIBERGLASS MOUNTING BRACKET. ADD A COUPLE OF DROPS OF EPOXI ON THE NUT. THIS WILL TO KEEP IT FROM SPINNING WHEN THE LENS IS REMOVED TO SERVICE THE LIGHT BULB.